

BiSemA

BiSemA Corporation

**Bringing better services
for
office furniture dealers**

Microsoft Partner

**FOUNDER
CEO**

BiSemA
BiSemA Corporation

BiSemA Corporation

- **Founder:**
 - Semegne A. Tafesse
 - B.Sc Architecture and Town Planning (AAU) Ethiopia
 - B.Sc Computer Science (York U) Toronto
 - **Work History**
 - Teknion Furniture Systems(www.teknion.com) 1997–2014 (17 years)
 - AutoCAD Operator
 - Prepare office furniture product catalogue (Database)
 - Supporting data and drawings for my current competitors
- At Teknion, I prepared the data & drawings for office furniture catalogues

**BiSemA Corporation incorporated
October 12, 2017**

BiSemA Corporation Status

- Registered by the Ontario government
- Microsoft Partner
- Will participate in [NeoCon – 2022](#), the largest annual furniture exhibition, at Chicago
- Integrate the solution using Microsoft Dynamics 365 Business Central
Microsoft Azure, AutoCAD, Revit, Augmented Reality and Autodesk Forge

Office Furniture Industry

According to [BIFMA](#) the office [furniture](#) business make more than [14.63 billion](#) in 2020 in N. America



OFFICE
FURNITURE DATA

Office Furniture Data

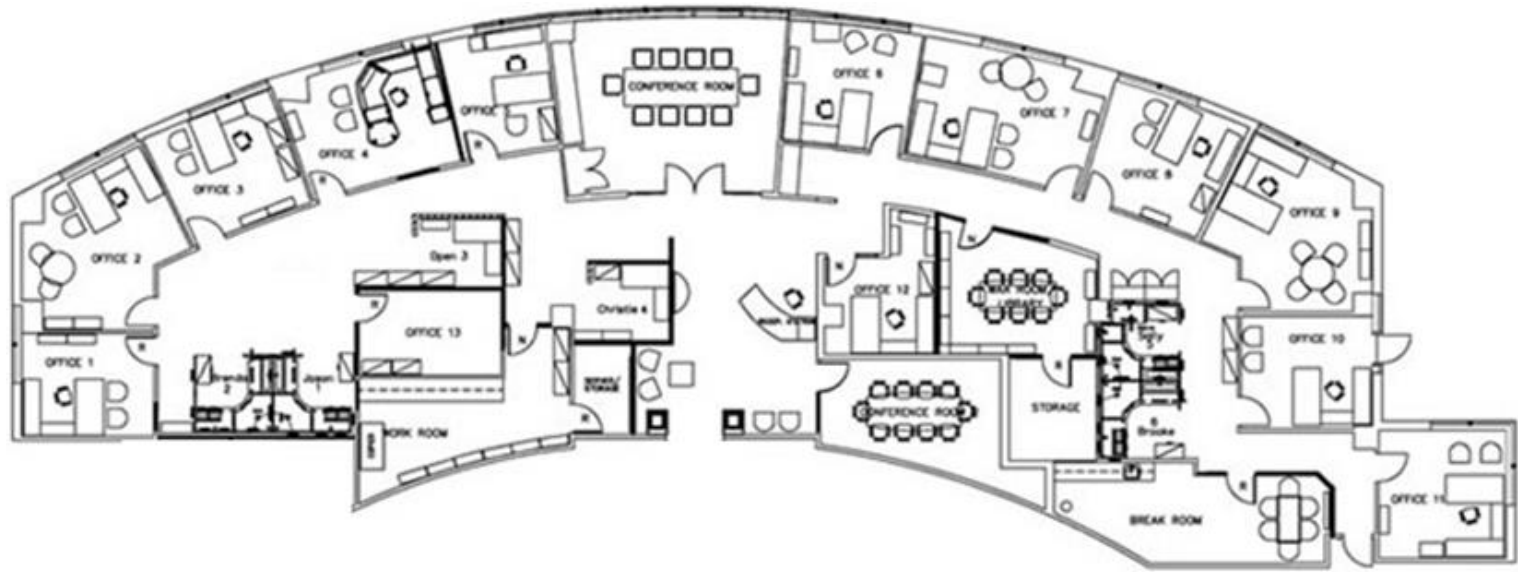

BiSemA
BiSemA Corporation

BiSemA competing with two types of software service

1) Furniture Specifications services

BiSemA brings cloud specification

- collaborative teamwork
- No installation
- Hold multiple releases of the same catalogue
- Integrated to ERP application
- No extra fee for Rendering and Augmented Reality services

2) ERP services for furniture companies

BiSemA brings Microsoft Dynamics 365 Business Central

- Cloud solution and no hardware or software
- Microsoft handle the software administration
- Price is very low \$70.00 US per month
- Integrated to the order entry and no manual work
- No dedicated staff is required

BiSemA SOLUTION

BiSemA Corporation

BiSemA SOLUTION

Microsoft Dynamics 365 Business Central

Dealer use Business Central to login Specification portal



- Collaborative work
- Lower subscription
- Intermediate service
- providing ERP
- AR Service
- Rendering

Updating furniture catalog data in 24 hours

Dealer sends sold specification products in SIF for manufacturing

Furniture Catalogue XML + DWG

Login Specification Portal

Pushed specification products

- AutoCAD
- Revit
- Forge
- Augmented Reality

Item Number	Tagname	Select	GR Profile	Product Image	Qty	Unit	Order Code	Product Description	Quantity	Unit Price	Total Price
1)	Type Ingre...				1	EA	5541	57320003 COFFINERACI...	1	2099.99	2099.99
2)	Type Ingre...				1	EA	5541	57320003 COFFINERACI...	1	2099.99	2099.99
3)	Type Ingre...				1	EA	57100025	57100025 PINKALPOL...	1	2025.99	2025.99
4)	Type Ingre...				1	EA	5541	57320003 COFFINERACI...	1	2029.99	2029.99
5)	Type Ingre...				1	EA	5541	57320003 COFFINERACI...	1	2045.99	2045.99

BiSemA Integrated Specification Portal

COMPARISON
INDEX

Flow of Furniture Data

Microsoft Partner

BiSemA

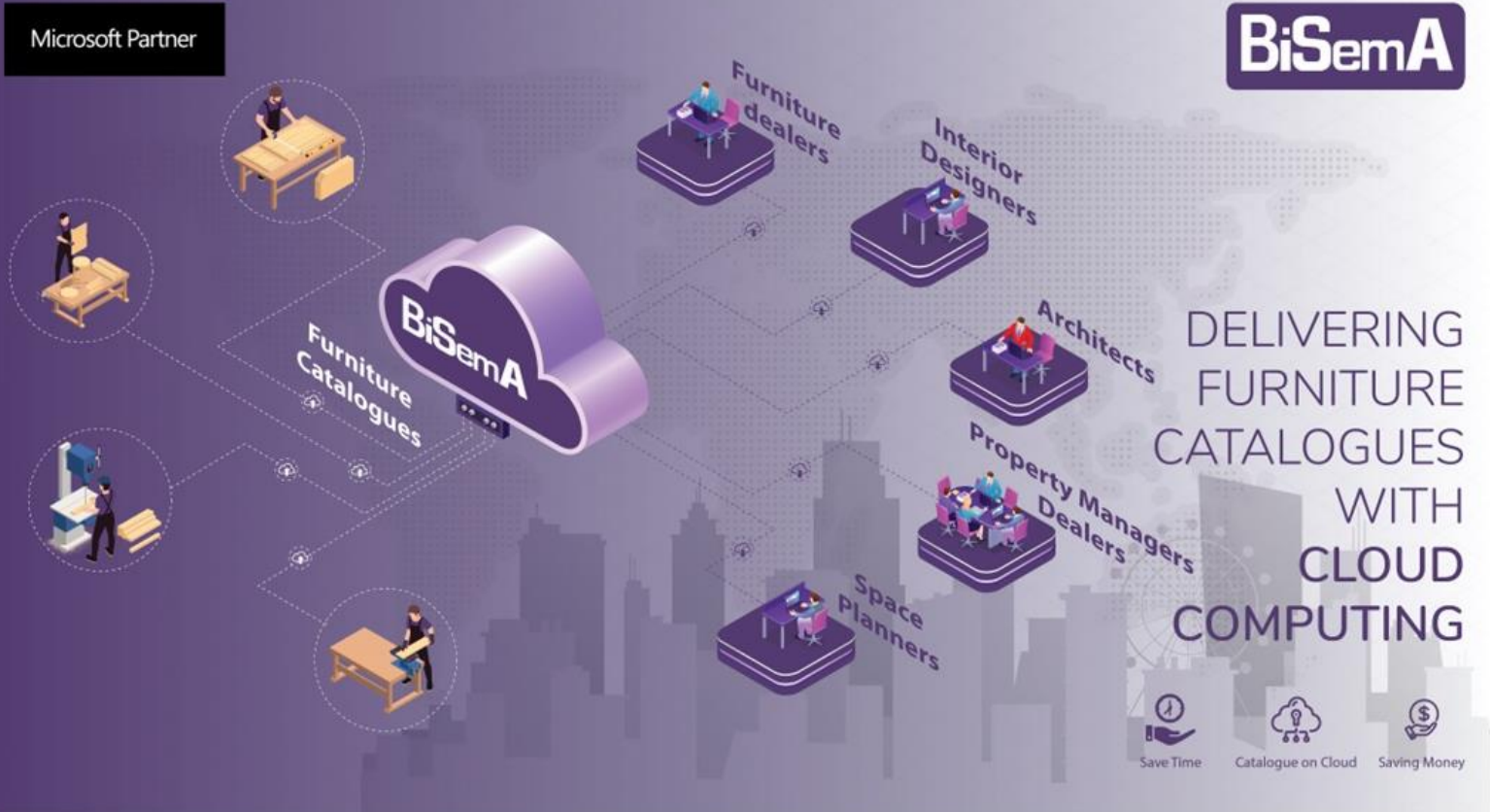

DELIVERING
FURNITURE
CATALOGUES
WITH
CLOUD
COMPUTING

BiSemA
BiSemA Corporation

Specification Comparison Index

**BiSemA Advantages of
Specification Services**

Specification Features	BiSemA
Product Specification, space layout in <u>AutoCAD</u> , import and export SIF file, for a quick quote and sales order	YES
Product Specification, space layout in <u>Revit</u> , import and export SIF file, for a quick quote and sales order	YES
Rendering services	Free Autodesk Forge
Integrated to ERP Application	NO
Receive DVD / Download software and catalogue installing in each release and updates	NO
Collaborative work many users for one project at a different location one sales order save time & money	YES
Updating furniture catalogue data	In an hour
eCommerce store integrated open to serve public	YES
Hold multiple release of the same catalog (Price protection)	YES
Connecting dynamically to Video, PPG, BIFMA certificate, Environment report when specifying products	YES

SaaS
INTEGRATION

BiSemA
BiSemA Corporation

Disruption Integration

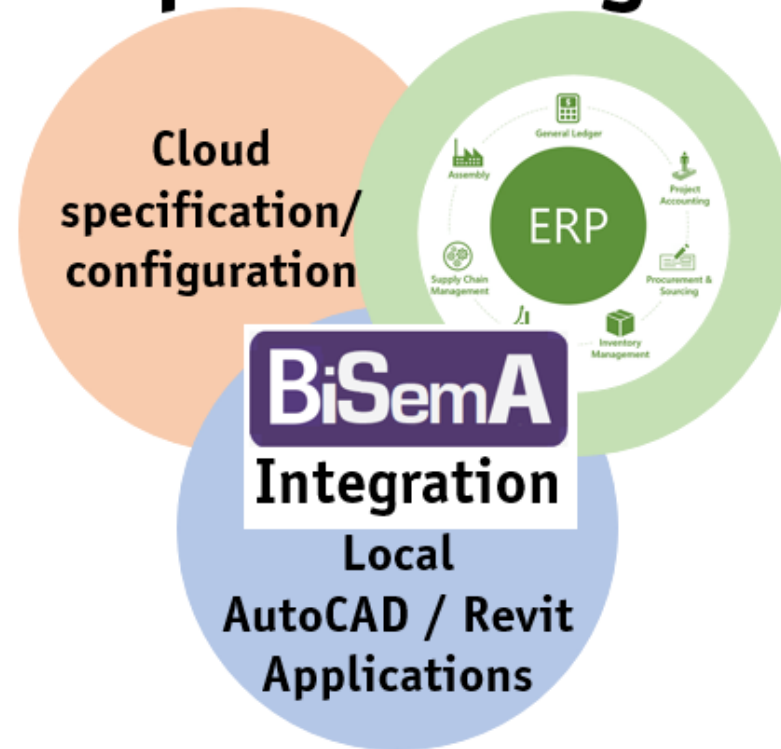

It is new SaaS Cloud-base
Application Platform

Dynamics 365 Business Central

CRONUS Canada, Inc. | Finance ▾ Cash Management ▾ Sales ▾ Purchasing ▾ Setup & Extensions ▾ | ☰

Customers Vendors Items Bank Accounts Chart of Accounts

Headline

Good afternoon, Semegne Tafesse!

Actions

- + Enable BiSemA
- + Sales Order
- + Purchase Order
- + BiSemA Cart
- + Sales Invoice
- + Purchase Invoice
- + Sales Quote
- + Purchase Quote
- > New

● ○ ○

Activities ▾

Sales This Month

\$3,565

> See more

Overdue Sales Invoice Amount

\$107,754

> See more

Overdue Purch. Invoice Amount

\$79,148

> See more

Sales Invoices Predicted Overdue

0

> See more

Ongoing Sales

Sales Quotes	Sales Orders	Sales Invoices
4	47	10
>	>	>

Ongoing Purchases

Purchase Orders	Ongoing Purch... Invoices	Purch. Invoices... Next Week
15	4	0
>	>	>

Payments

Unprocessed Payments	Average Collec... Days	Outstanding V... Invoices
1	0.0	15
>	>	>

Product Items
In D365BC

Items pushed to D365BC

BiSemA
BiSemA Corporation

Dynamics 365 Business Central

Item Card | Work Date: 8/21/2021

1100 · BSA Executive Seat 501

✕ If you want, we can assign attributes based on the images you import for items and contacts. Enable | Don't ask again

Process | Item | Prices & Discounts | Request Approval | Actions | Related | Reports | Fewer options

Item Show more

No.	1100	Catalog Three L...	bsa1
Description	BSA Executive Seat 501	Catalog Release...	5/23/2018
Blocked	<input type="checkbox"/>	Full Specificatio...	ST501EX02 ?? ?? ?? ??
User Id	1	Tag Name	office
Manufacturing ...	BSA - 3 CAD's BiSemA Cat	Type	Inventory
Manufacturing ...	BSA	Base Unit of Me...	PCS
Catalog Name	bsa1	Item Category C...	

Inventory Show less

Shelf No.		Qty. on Asm. Co...	0
Created From C...	<input type="checkbox"/>	Stockout Warning	Default (Yes)
Search Descripti...	BSA EXECUTIVE SEAT 501	Prevent Negativ...	Default (No)
Inventory	0	Net Weight	0

Details | Attachments (0)

Picture ▼



Item Attributes ▼

Attribute	Value
(There is nothing to show in this view)	

Product Specification in Azure

BiSemA Corporation
BiSemA Corporation Cloud Specification Services

Project Name : Friday_May06
Dealer Name : Dealer202
Small Cart[9]

Specification
Shopping Cart [9]
3D + AR Viewer

Manufacturing Company



FLC Catalogue:

Search:

Blade

- ▶ Blade Panels
- ▶ Structures
- ▶ Dividers
- ▶ Upmounts
- ▶ Fixed Height Worksurfaces
- ▶ Height Adjustable Worksurfaces
- ▶ Height Adjustable Bases
- ▶ Accessories
- ▶ Storage
 - ▼ Low Credenza
 - 7SLC184824BFO**
 - 7SLC184824OBF
 - 7SLC185424BFO
 - 7SLC185424OBF
 - 7SLC186024BFO

FLC| Blade
Live Chat | Dealers Board

FLC | STORAGE | LOW CREDENZA FLC | Award

Product Description: LOW CREDENZA 18"D X 48"W X 24"H BOX / FILE / OPEN Download PDF: ANSI / BIFMA-Certificates | Price Product Guide | Installation Guide | Environment Data

Product: **7SLC184824BFO**

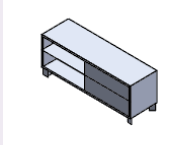

Other Low Credenza sizes



7SLC184824OFO



7SLC184824OBF

Description

Low Credenza

FEATURES----- What's Included: Low credenza storage unit on edge feet Finish Options: See pages 24-25 for storage - top, contrast and base & storage - handles Grade 1 refers to Thermofused laminate (TFL) contrast Grade 2 refers to High pressure laminate (HPL) contract information Required to Order.Credenza code / TOP, Contract, Base and handle Example Spec: 7SLC1860OBF/TNW/CAW/BNW/BR1 (Top in Nova White, Contrast in Amait walnut, Base in Nova White, Bar handle

Product Code

7SLC184824BFOTCBTTHMCIPCTFGBNWNW

\$1150.00 Qty - 1 +

Add to Cart

Download

	DWG	DXF	Revit
2D	<input type="checkbox"/>	<input type="checkbox"/>	<input type="checkbox"/>
3D	<input type="checkbox"/>	<input type="checkbox"/>	<input type="checkbox"/>

Download

Shopping cart

Shopping cart





BiSemA
BiSemA Corporation

BiSemA Corporation

Project Name : Remark project 1 Dealer Name : BiSemA Dealer

Specification Shopping Cart [5] 3D + AR Viewer

List of products in cart [Order Special Product](#)

Manufacturing Company	Item Number	Tagname	Select	Edit Finish	Product Image	Mfg	Cat	Order Code	Product Descriptions	Quantity	Unit Price	Total Price
fluid concepts FLEXIBLE WORKSPACES	1)	Type tagname ...	<input type="radio"/>	<input type="radio"/>		BSA	BSA1	ST501EX03 L2SF4BF4BS4CS4	BSA Executive Seat 609	- 1 +	\$999.99	\$999.99
FLC Catalogue bld	2)	Type tagname ...	<input type="radio"/>	<input type="radio"/>		BSA	BSA1	ST502GC03 ??? ??	BSA Guest Chair 687	- 1 +	\$289.99	\$289.99
Blade Blade Panels	3)	Type tagname ...	<input type="radio"/>	<input type="radio"/>		BSA	BSA1	ST502GC05 4FS34UF24LG5	BSA Guest Chair 541	- 1 +	\$205.99	\$205.99
<ul style="list-style-type: none"> Gable, End Condition, Left Gable, End Condition, Right Gable, Mid Condition Side, End Condition, Left Side, End Condition, Right 	4)	Type tagname ...	<input type="radio"/>	<input type="radio"/>		BSA	BSA1	ST502GC07 ??? ??	BSA Guest Chair 742	- 1 +	\$228.99	\$228.99
	5)	Type tagname ...	<input type="radio"/>	<input type="radio"/>		BSA	BSA1	ST502GC09 ??? ??	BSA Guest Chair 728	- 1 +	\$345.99	\$345.99

Autodesk
Forge

Autodesk Forge

BiSemA
BiSemA Corporation

BiSemA

BiSemA Corporation

Select the folder and click right mouse to upload a file

20220414090258
April14.dwg

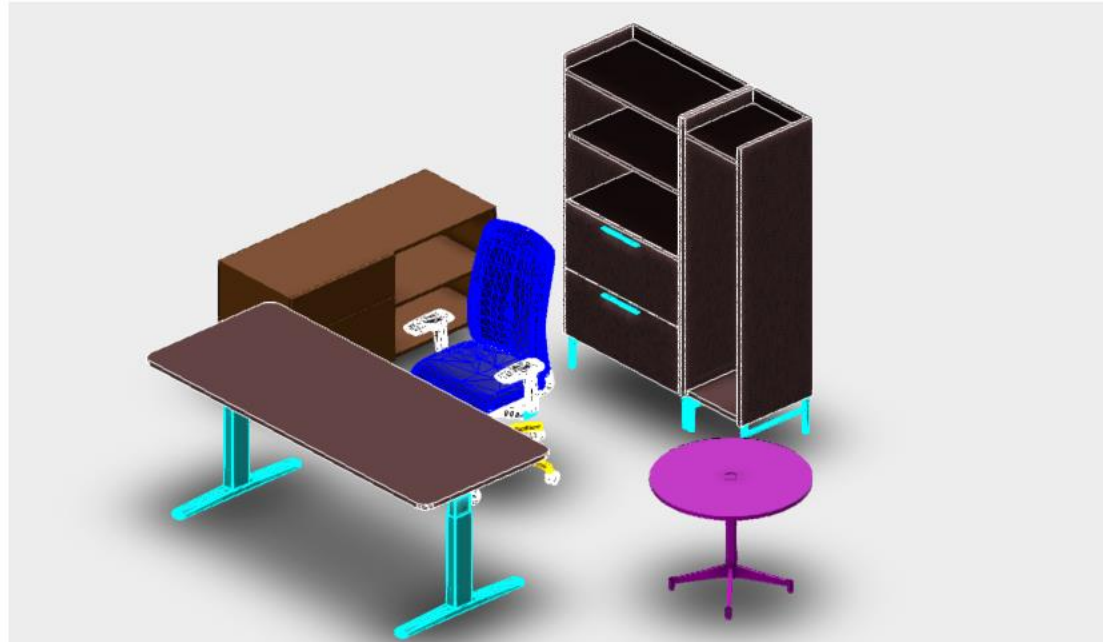

THANK YOU !

BiSemA
BiSemA Corporation

BiSemA Corporation Contact

- **Website**
 - <https://www.bisema.com>
- **E-mail**
 - semegne.tafesse@bisema.com
- **Phone**
 - (416) 409 – 7579
- **Address**
 - Toronto, Ontario Canada