



# Email Security

Email Privacy & Compliance.  
Data Leak & Human Error Prevention.  
Thwart Cybercriminal Payment Lures.

Holistic AI-Infused Email Security Layers at the Security Gateway and Integrated into the Inbox.

Handcrafted in California, Served to the World. Since 2000.  
The Global Standard in Secure & Certified E-Communications.

Explore Our  
Secure Email  
Services



Email Privacy & Compliance



Human Error Prevention & DLP



Targeted Attack Pre-emption



Certified Proof of Content Delivered



Outbound AI Security Stack



## ▶▶ Customer Stories

**Applied Systems is the world's largest insurance agency management platform. Their customers have trusted RMail email security for more than a decade. Now Applied Systems is building the newest RMail innovations – its AI-infused impostor email and human error protection suite plus dynamically simplified email encryption – into its main platforms, OEM-esque.**

California  
R&D

70+  
Patents

100%  
AI-Infused

190+  
Countries

[www.RMail.com](http://www.RMail.com)



## Email Privacy & Compliance

### SMARTR Email Encryption

Dynamically adapting encrypted email ensures elegantly easy; simple for recipient means happy sender. Far beyond opportunistic TLS, RMail encrypted email service smartly adapts to provide peace-of-mind with end-to-end encryption, secure file sharing, auditable proof of fact of GDPR and HIPAA privacy compliance, email thread security monitoring, and more.



## Human Error Prevention & DLP

### Mutating the DNA of Data Leaks

Automatically sensitize users of their need to treat certain messages differently, seamlessly and in the flow of email and work, with in-the-moment-of-sending, bite sized insights and alerts. Empower your people and prevent data loss with AI-Infused and automated rules-based email compliance and security recommendations.



## Targeted Attack Pre-emption

### Intercepting the Human Instinct to Please

Nip cybercriminal-induced mis-wires (a/k/a wire fraud) with real-time alerts that expose whose email account is being eavesdropped on, which email addresses have tricky lookalike domains, and when a reply is about to be hijacked--must-have additional layers for your Business Email Compromise defense. Outbound Pre-Crime™ email security at its finest!

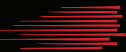

## Certified Proof of Content Delivered

### Proof of Who Said What When, by Email

Gain insights of the overall journey of your email, how popular who read what when, and receive forensic certified proof.



## Outbound AI Security Stack

### Perfect Harmony, Enhance the Outbound

Keep your existing inbound email security – and even your outbound DLP if you so choose. Add RMail outbound security gateway, in-the-inbox integrated cloud email security, and in-the-ether e-security content controls: all, some or one. RMail harmoniously extends your existing email security systems, adding elegantly-easy encryption user experiences, unique BEC targeted attack detection, and more, with AI DLP automation.

## Why We Are Unique

Our features provide the best user experience. Our prices make us the most affordable. And our services connect elegantly inside your existing email programs and business systems.



### Breadth of Services

RMail empowers you; all of the functionality you need, all in one installation onto the platforms you're already using -- email encryption, certified proof, AI-infused human e-security error prevention, in-the-moment personalized e-security training, and much more.



### Simplicity

We understand that the power of e-security technology resides in user adoption. That is why RMail is built with AI that automatically sensitizes users to today's e-security and e-compliance needs, subtly nudging them to make the right email-related e-security decisions. Securing your business has never been easier.



### Legal Proof®

Each message comes with a Registered Receipt™ email record; the global standard for court-accepted, timestamped proof of secure delivery of emails — and its attachments. This record is durable (it may be forwarded, retaining its self-authenticating integrity), and is self-contained (it does not require any other record to be stored anywhere).



### Friendlier Service

Excellent technology is key, outstanding service is gold. Getting both in a single package is pure bliss. Our teams are more knowledgeable and friendlier to work with. That is why our customers rate us with 99% satisfaction scores and 5-star accolades.

Thank you, to the more than **25 million people** the world over, who have put their trust in our team and technology, **since 2000.**



### RMail Security Flow

RMail Outbound Cloud Security Platform most often acts as an extension of one's existing inbound email security filters and outbound DLP services, with specialized Email Eavesdropping™ protection, elegantly easy and automated email encryption, and more.

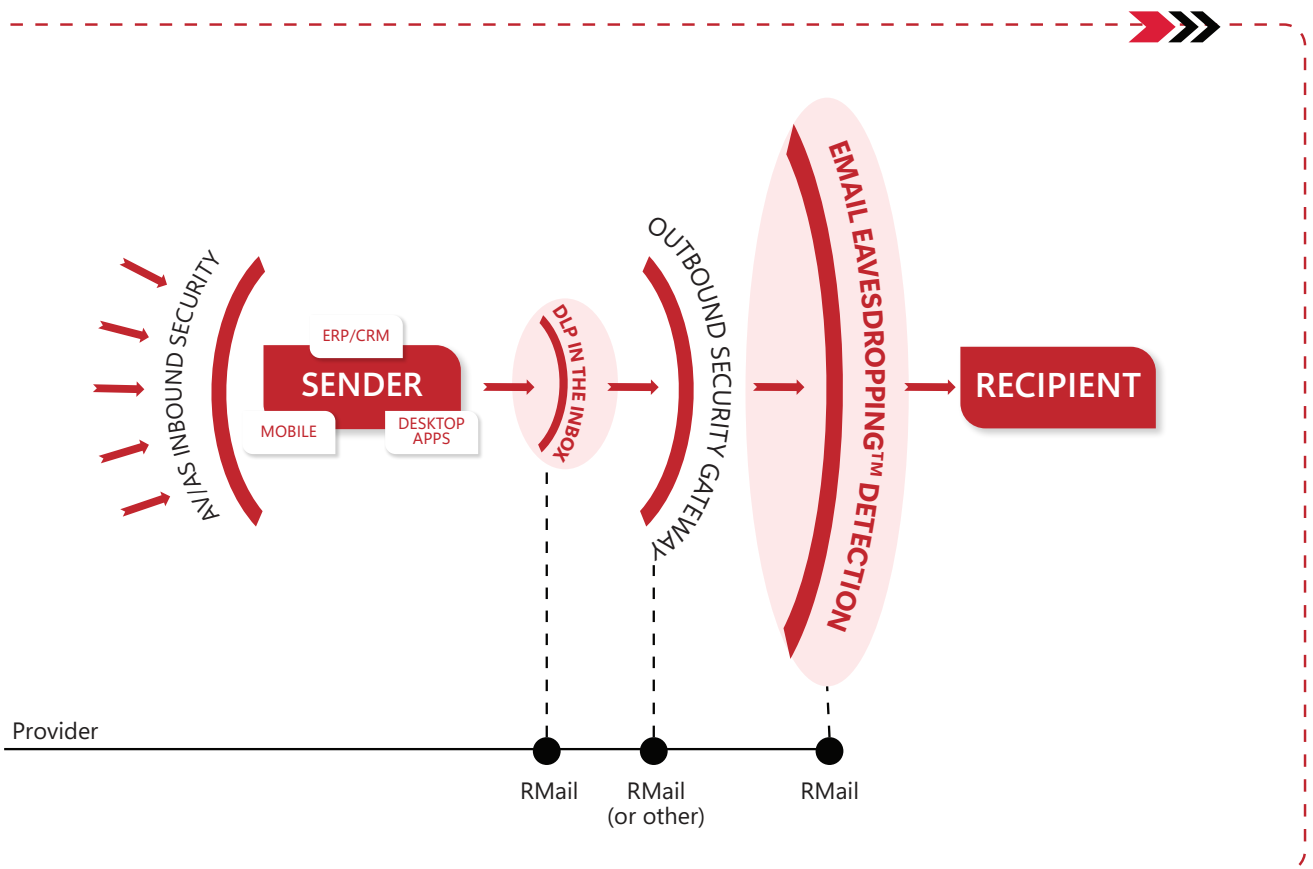

RMail services detect when a message should be sent encrypted and automatically transform it into a secure message that recipients can view with ease.

With Email Eavesdropping™ threat hunting, senders have peace-of-mind that they will be alerted in real time if a cybercriminal has compromised their recipient's email inbox, which is often the main step in lures leading to mis-wires.

RMail then sends aggregate Email Eavesdropping™ red-alerts to administrators and, if desired, to their managed security service provider as well.

## All-in-One in the Inbox

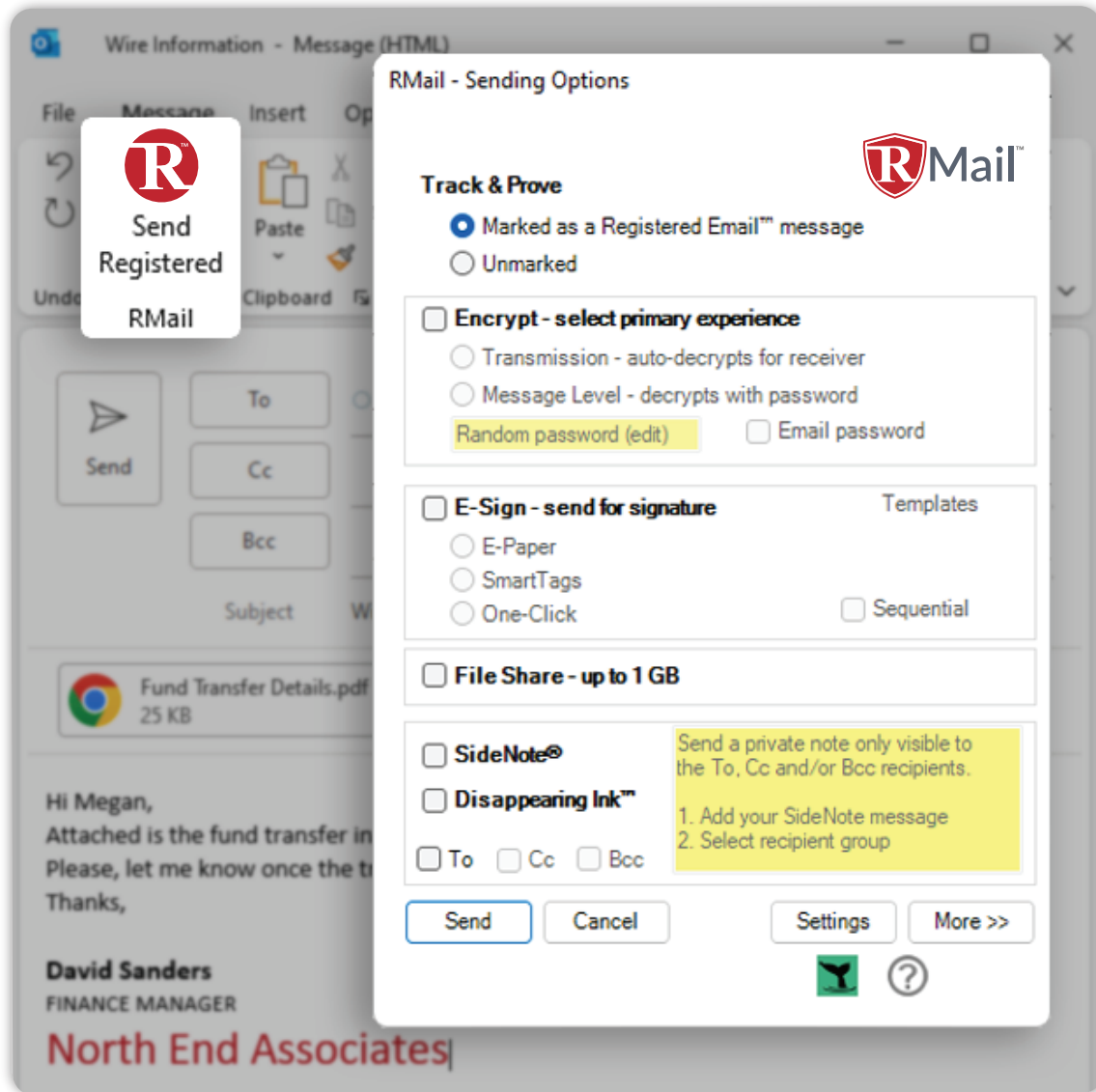

RMail installs seamlessly into Microsoft Outlook, Gmail, Salesforce and more to empower users with its full set of email security, DLP, privacy compliance and productivity tools at the click of a button.



## RMail Recommends™ DLP in the Desktop

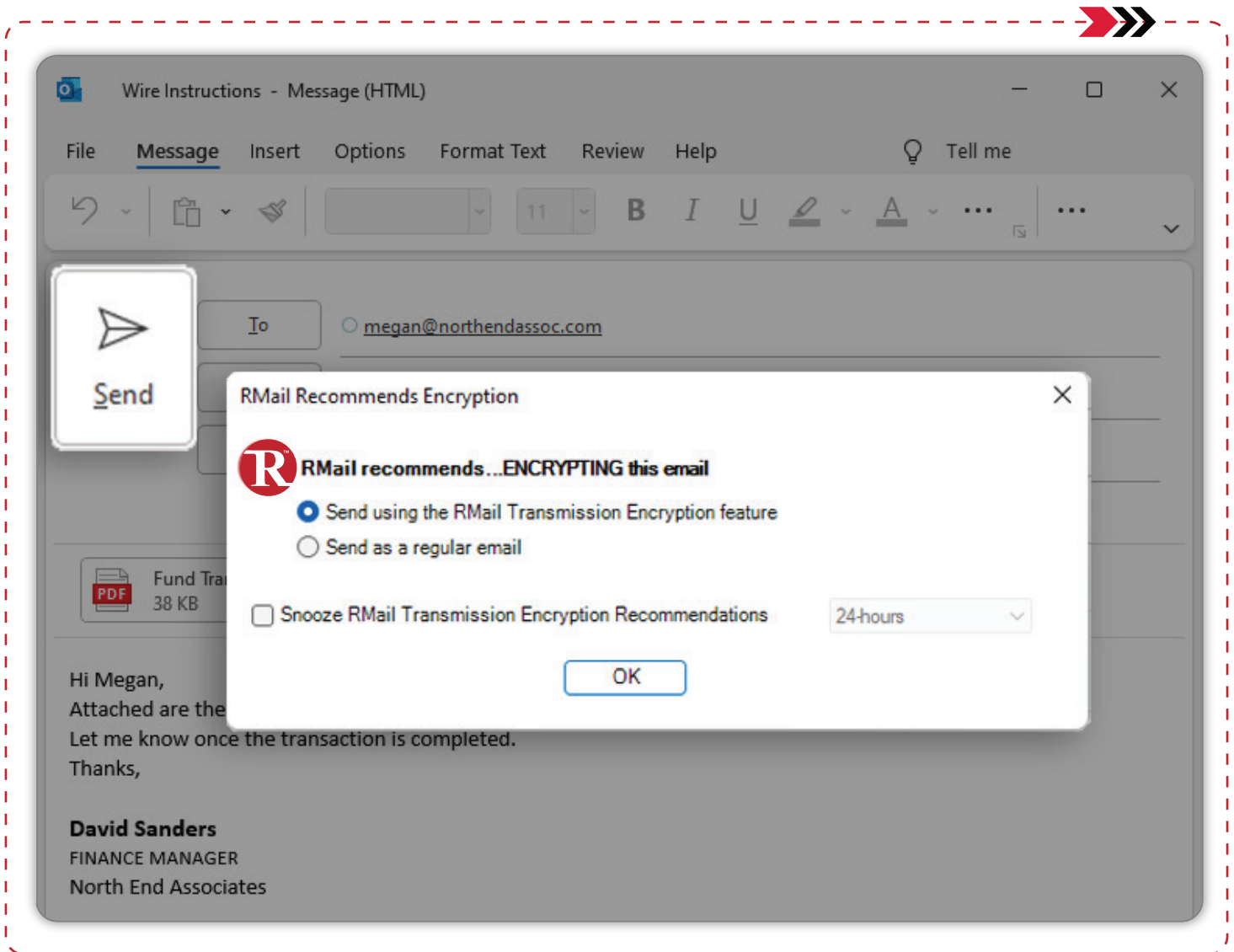

RMail automatically sensitizes users to the need to treat certain email with special care; and then transforms the message with specialized security in mind. This is true DLP in the desktop, no server settings or routings needed. For the sender, it's just like sending any other email. For IT admins, it's peace of mind with pure email security and compliance bliss.

## Right Recipient™: Lookalike Domain™ Detector

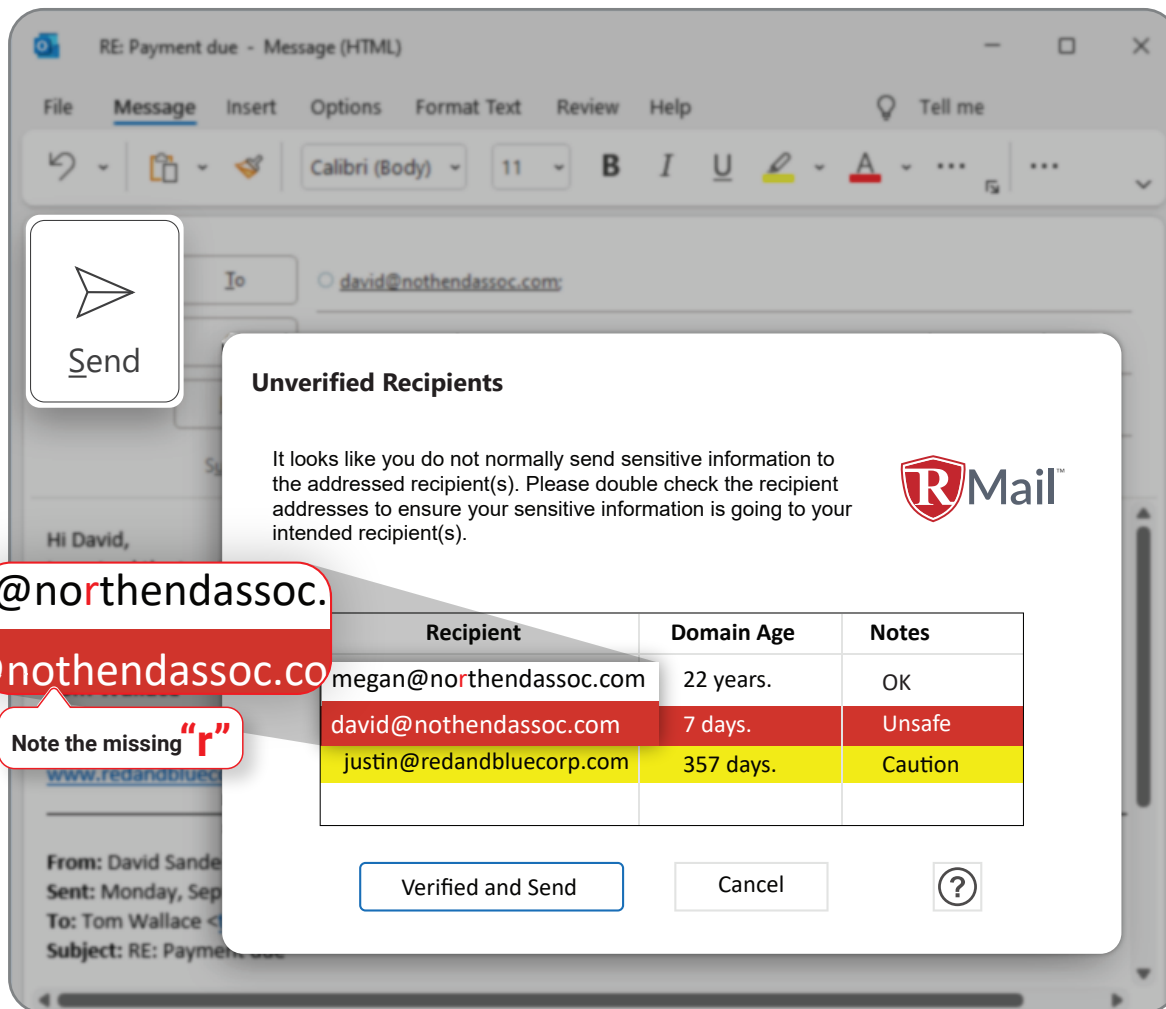

Send

**Unverified Recipients**

It looks like you do not normally send sensitive information to the addressed recipient(s). Please double check the recipient addresses to ensure your sensitive information is going to your intended recipient(s).

Recipient	Domain Age	Notes
megan@northendassoc.com	22 years.	OK
david@nothendassoc.com	7 days.	Unsafe
justin@redandbluecorp.com	357 days.	Caution

Verified and Send    Cancel    ?

Note the missing "r"

In this example, the cybercriminal has newly purchased a domain with one letter different -- missing the "r" -- to effectively hijack the reply and continue corresponding, posing as a long-time contact.

After an email is deemed important enough to send in a special RMail way, RMail presents the full email address of each recipient to make it easy for senders to re-verify that they are about to send **the right message to the right recipient**. And, if RMail identifies any cybercriminal trickery in the email addresses, such as clever domain misspells or tricky message header reply-to pivots, it instantly alerts the sender.

## Right Recipient™: Reply Hijack™ Alerts

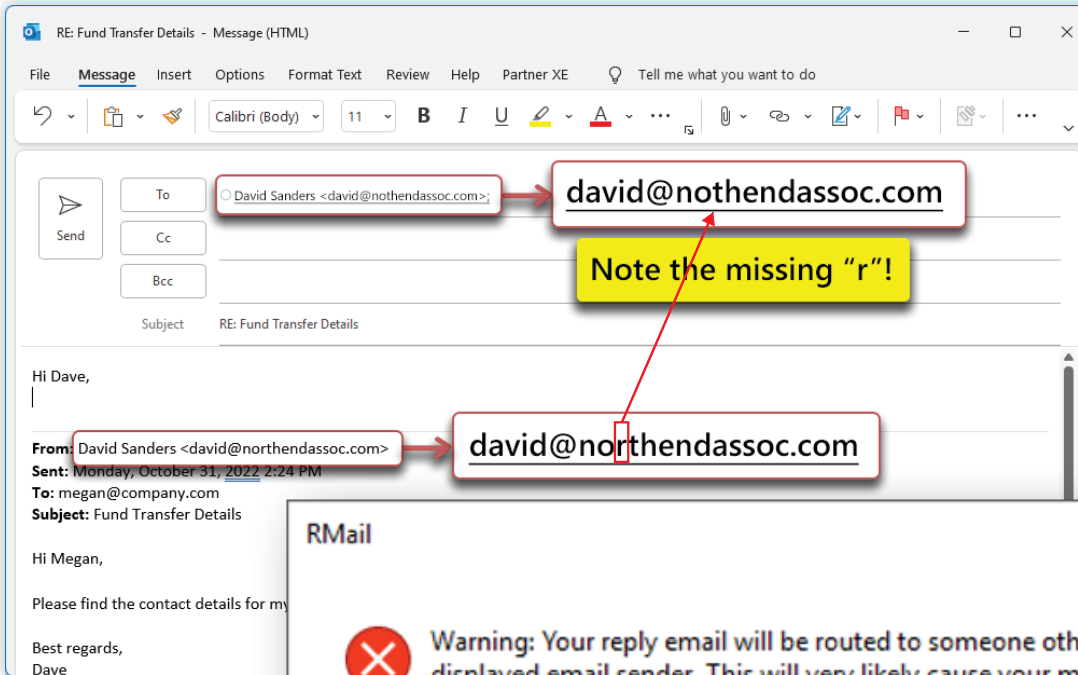

The looklike reply domain is not visible to human eyes until after the sender clicks reply, at which time it is very difficult for the sender to spot.

This feature will alert senders **after the hook is in, before the steal**, in-the-moment of replying or forwarding a message, if RMail detects a message will pivot from the intended recipient.

This method, combined with the utilization of impostor domains, is one of the most common ways in which cybercriminals hijack a thread, and one of the first steps towards wire fraud.

### SMART<sup>™</sup> Encryption

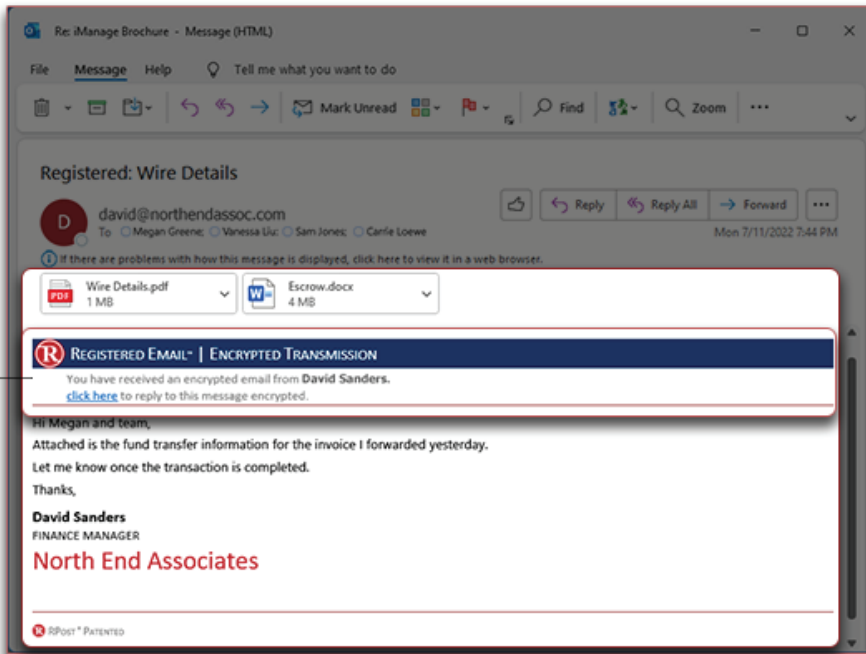

#### Transmission Preferred Encryption:

RMail's default settings first attempt transmission level encryption at the minimum sender-acceptable security level, and deliver the encrypted email right to the recipient's inbox, providing the same familiar user experience as a normal email: **without any logins, links or need to create an account.** Recipients even have the option to reply encrypted.

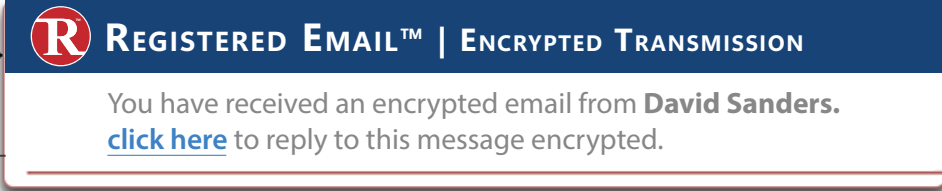

#### Benefits:

- The banner adds confidence for the receiver that the information was shared securely
- Familiar user experience
- No logins, links or need to create an account

[click here](#) to reply to this message encrypted.

#### Benefits:

- Recipient can reply encrypted
- Option to attach up to 200MB of files securely in the reply

### SMART<sup>™</sup> Encryption

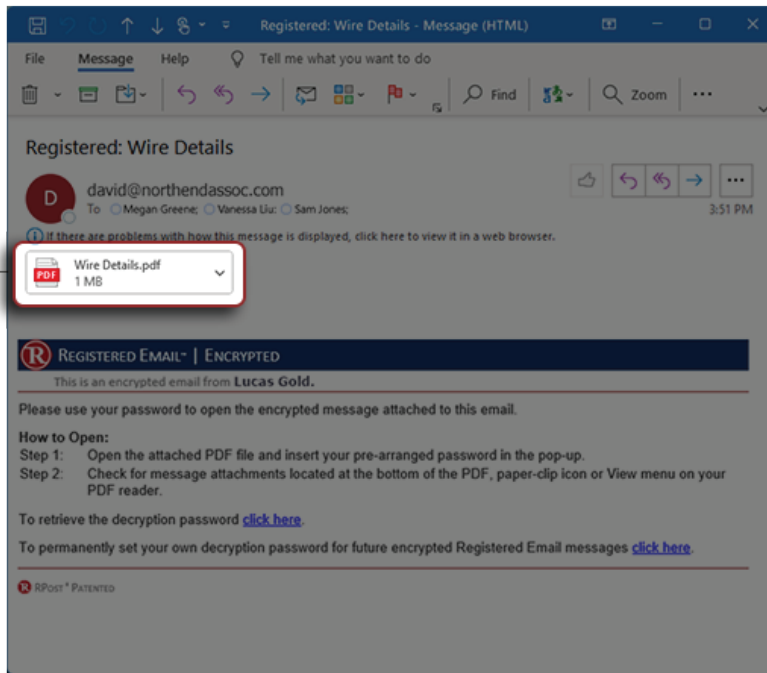

#### Message Level Encryption

RMail dynamic encryption engine detects whether the recipient's server is able to receive the email at the minimum sender-acceptable security level and, if not, automatically reverts to message level encryption, wrapping the email and any attachments inside an AES-256-bit encrypted PDF package, delivered into the recipient's inbox, with automated decryption password management.

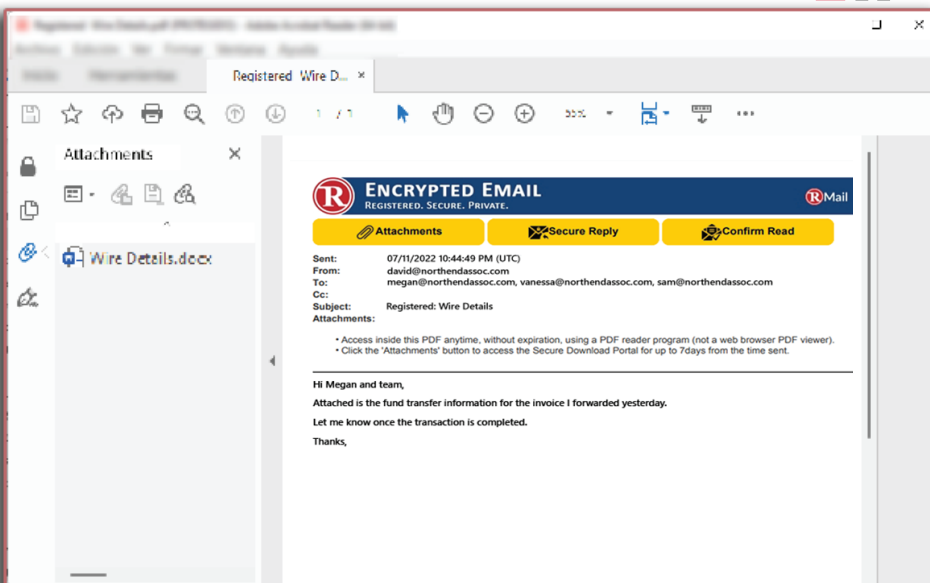

#### Benefits:

- Message and attachments remain encrypted at rest in the recipient's inbox
- Familiar and easy PDF user experience for reader
- The email opens in any browser or PDF reader
- Digitally signed, integrity visible in the PDF reader
- Recipient can access the attachments in any browser with a simple click, or directly in their PDF reader



### Secure File Share™ Send Up to 1GB from within Outlook

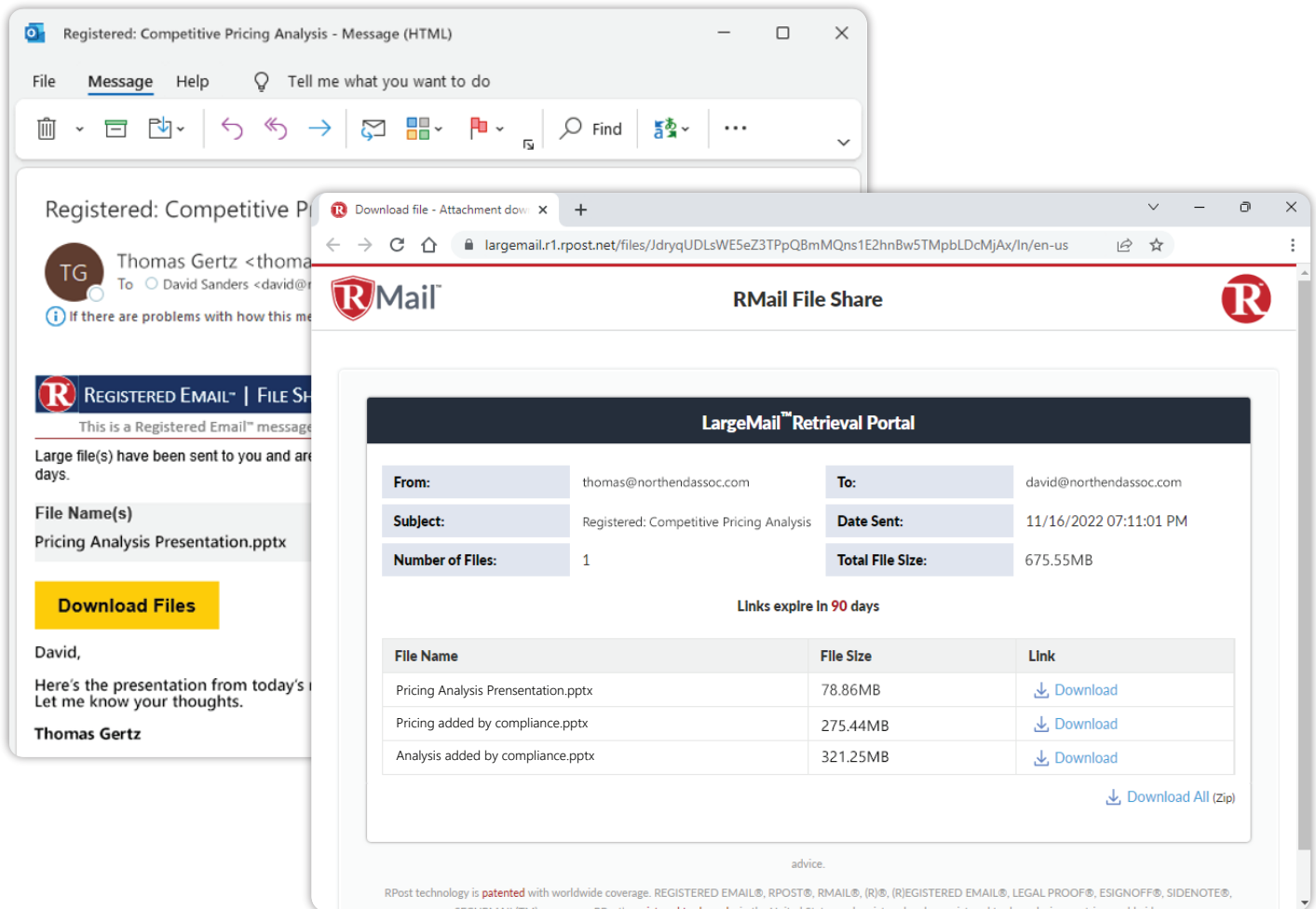

The image shows a screenshot of an Outlook email window and a browser window displaying the RMail File Share portal. The Outlook window shows an email from Thomas Gertz to David Sanders with a subject of 'Registered: Competitive Pricing Analysis'. The browser window shows the RMail File Share interface with a 'LargeMail™ Retrieval Portal' for the same email. The portal displays the sender and recipient information, the subject, the number of files (1), and the total file size (675.55MB). It also shows a table of files with their names, sizes, and download links. The links expire in 90 days.

File Name	File Size	Link
Pricing Analysis Presentation.pptx	78.86MB	<a href="#">Download</a>
Pricing added by compliance.pptx	275.44MB	<a href="#">Download</a>
Analysis added by compliance.pptx	321.25MB	<a href="#">Download</a>

[Download All \(Zip\)](#)

Senders can easily attach and track up to 1GB of files right from inside the Outlook compose window -- or any of the RMail web applications. Senders can send large files securely to any recipient with encryption and configurable self-purging options (from 1 to 90 days) through a secure web container that eliminates the risk of download recipients being able to see sender's cloud storage file structure.

**Plus, files auto-purge after 1 to 90 days (configurable) and can be killed early at any time by the sender. No files linger on the Internet – pure compliance bliss.**

## Digital Seal®: Authenticate True Email Content & Sender

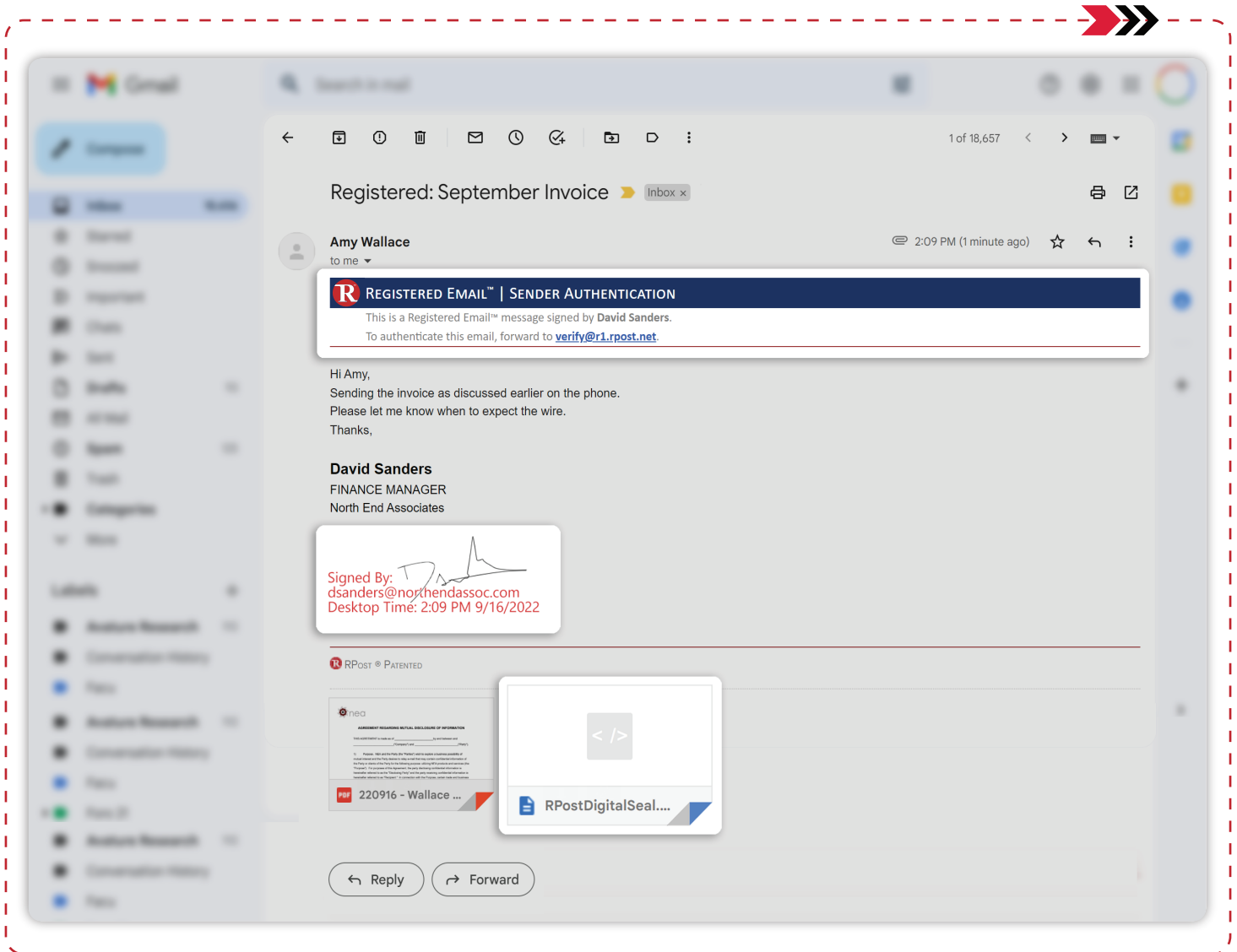

RMail Digital Seal® authentication makes it easy for a recipient to verify origin and authorship of an email (for example, an email carrying an invoice) and re-create a copy of the original message content instantly. This empowers the recipient of the invoice to verify authenticity of payment information in real-time, anytime, before paying.

### Redact+ Protect-the-Thread™ With In-the-Message DLP

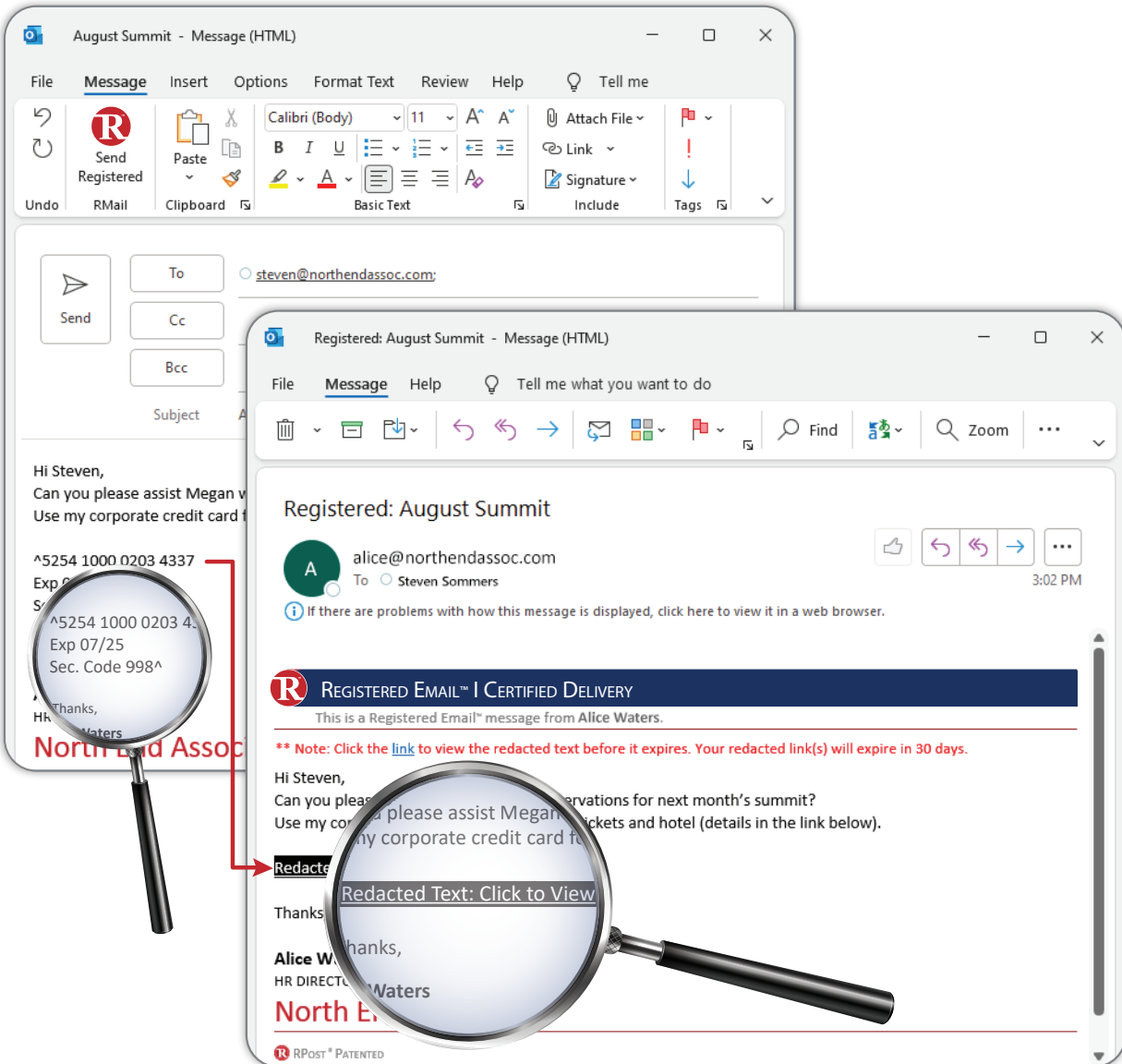

Senders are now empowered to ensure that certain content of an email – like payment details, negotiated terms, or other sensitive content – is redacted from the message body. It protects the sender by automatically cleansing the email thread of sensitive content while at the recipient regardless of how a recipient replies or who they forward the message to.

### Double Blind Cc™ & Private SideNote®

AS SENT

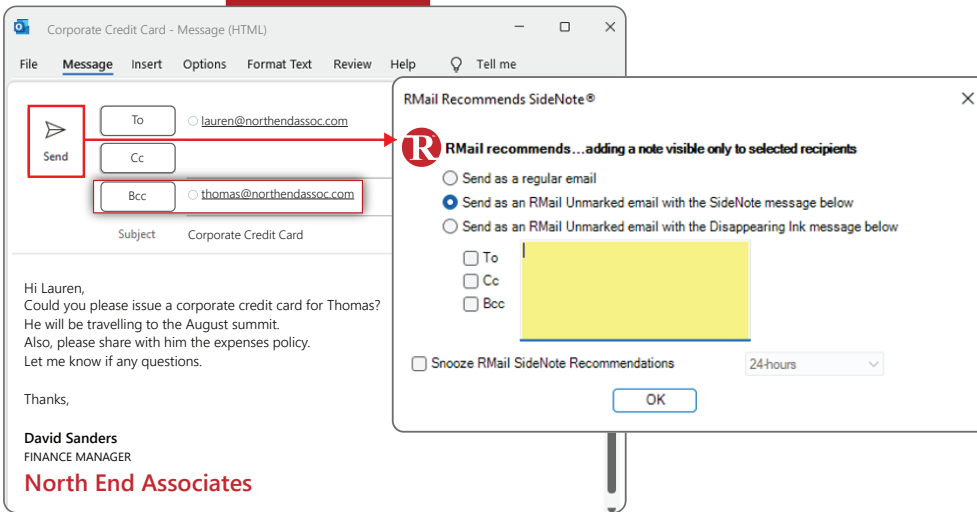

In the normal process of sending an email, RMail AI detects whether it may be useful for senders to add contextual SideNote® message visible only to selected recipients. When used in combination with Disappearing Ink™, that note can be set to disappear after read, without any trace.

Senders can redact addresses in the To/Cc fields, such that recipients in Bcc can see who was copied but cannot inadvertently reply to all, exposing that they were blind copied.

AS RECEIVED

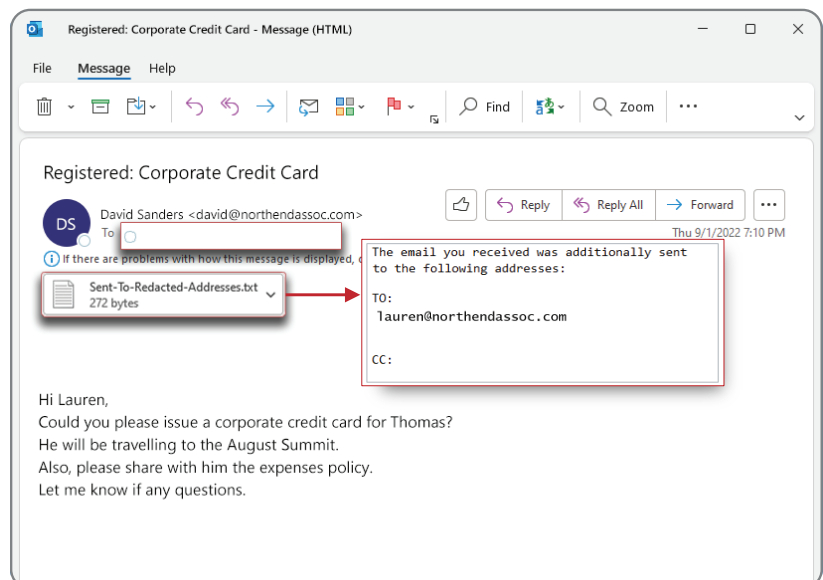

# Legal Proof®: Email Content Delivered

## The Power of Proof™:

The Registered Receipt™ email record is a durable, self-contained, and self-authenticating proof record of the entire email transaction, returned to the sender for each Registered Email™ sent. The Registered Receipt™ authenticates and accurately reproduces the original email including attachments, without RMail or any third party storing a copy of the email, attachments or records.

HTML file reconstructs the transaction, is durable and self-contained.

Message status and metadata of the transaction is contained in XML format or can be extracted via API.

Legal delivery time, synched to the Government Atomic Time

Legal delivery status

Legal time of sending

Record of encrypted transmission

Record and identifiers for proof of attachment content

Legal forensic metadata

To tom@northendassoc.com Sun 4/5/2020 9:40 PM

DeliveryReceipt.xml 17 KB    HtmlReceipt.htm 960 KB

**REGISTERED RECEIPT**  
EVIDENCE OF DELIVERY, CONTENT & TIME

This receipt contains verifiable proof of your RPost transaction. The holder of this receipt has proof of delivery, message and attachment content, and official time of sending and receipt. Depending on services selected, the holder also may have proof of encrypted transmission and/or electronic signature.

To authenticate this receipt, forward this email with its attachment to 'verify@r1.rpost.net'

Address	Status	Details	Delivered (UTC*)	Delivered (local)	Opened (local)
drlucasjones@outlook.com	Delivered and Opened	MUA+HTTP-IP:76.118.20.145	4/6/2020 2:40:19 AM (UTC)	4/5/2020 10:40:19 PM (-4.0)	4/5/2020 10:40:37 PM (-4.0)
bobdavisinsurance@gmail.com	Delivered and Opened	HTTP-IP:74.125.151.18	4/6/2020 2:40:20 AM (UTC)	4/5/2020 10:40:20 PM (-4.0)	4/5/2020 10:40:23 PM (-4.0)
alice@northendassoc.com	Delivered to Mail Server	relayed:mx-biz.mail.am0.yahoodns.net (67.195.228.75)	4/6/2020 2:40:22 AM (UTC)	4/5/2020 10:40:22 PM (-4.0)	
mark@northendassoc.com	Delivery Failed	5.1.2 (bad destination system: no such domain)	***	***	

\*UTC represents Coordinated Universal Time. <https://www.rmail.com/resources/coordinated-universal-time/>

**Message Envelope**

From: tom@northendassoc.com <tom@northendassoc.com>  
 Subject: Insurance Policy Review  
 To: <drlucasjones@outlook.com> <bobdavisinsurance@gmail.com>  
 Cc: <alice@northendassoc.com> <mark@northendassoc.com>  
 Bcc:  
 Network ID: <0bfd01d60bbc5b093ed10\$11b0c730\$@northendassoc.com>  
 Received by RMail System: 4/6/2020 2:40:18 AM (UTC)  
 Client Code:

**Message Statistics**

Tracking Number: F95542A9A2EEEBB4509C10C04569371335F2C815  
 Message Size: 638204  
 Features Used: R, i  
 File Size (bytes): 460330    File Name: Insurance Policy Review.pdf

**Delivery Audit Trail**

4/6/2020 2:40:18 AM starting outlook.com/mta-tls ln 4/6/2020 2:40:18 AM connecting from mta21.r1.rpost.net (0.0.0.0) to outlook-com.olc.protection.outlook.com (104.47.0.33) ln 4/6/2020 2:40:18 AM connected from 192.168.10.11:54337 ln 4/6/2020 2:40:18 AM >>> 220 HE1EUR01FT033.mail.protection.outlook.com Microsoft ESMTTP MAIL Service ready at Mon, 6 Apr 2020 02:40:18 +0000 ln 4/6/2020 2:40:18 AM >>> EHLO mta21.r1.rpost.net ln 4/6/2020 2:40:18 AM >>> 250 HE1EUR01FT033.mail.protection.outlook.com Hello

### Benefits:

- The Registered Receipt™ is the only evidence that needs to be stored to reconstruct the original transmission
- Self-authenticates without the need for third-party storage
- Reconstructs the entire transaction in native format, including content and attachments
- Can be forwarded for recipients to authenticate



# Legal Proof®: Email Content Delivered

**Receipt: Insurance Policy Review**

Authentication <support@r1.rpost.net>  
To: tom@northendassoc.com  
Tue 11/29/2022 7:37 PM

Attachments: Project: Recreate User Interfaces in editable format (39.5 KB), SMTP Log-1.txt (2 KB), SMTP Log-2.txt (3 KB), SMTP Log-3.txt (3 KB), SMTP Log-4.txt, SMTP History-1.txt

**RECEIPT AUTHENTICATION**  
PROOF OF DELIVERY, CONTENT & TIME

The receipt you have submitted to our system is valid and proves the delivery results displayed below.  
\*\* A copy of the original message is attached. \*\*

Address	Status	Details	Delivered (UTC*)	Delivered (local)	Opened (local)
drlucasjones@outlook.com	Delivered and Opened	MUA+HTTP-IP 173.203.187.145	10/17/2022 09:25:59 PM (UTC)	10/17/2022 02:25:59 PM (UTC - 07:00)	10/17/2022 03:13:52 PM (UTC - 07:00)
bdavis@davisinsurance.com	Delivered to Mailbox	HTTP-IP:85.255.233.64	10/17/2022 09:25:59 PM	10/17/2022 02:25:59 PM (UTC - 07:00)	

SMTP History - Notepad, HTTP\_Record-3 - Notepad, \*DSN\_Record-1 - Notepad

Message Envelope:  
From: tom@northendassoc.com  
Subject: Insurance Policy Review  
To: Lucas Jones, Brian Davis, Alice Liu, Mark Letterman  
Cc: Tom Millberg  
Bcc: Tom Millberg  
Network ID: RPost-123456789  
Received by RMail System: 11/29/2022 7:37 PM  
Client Code: RPost-123456789

Insurance Policy Review - Message (HTML)  
Hi Lucas and team,  
Attached is the new policy, per our conversation.  
Please review and let me know if any more changes are needed.  
Thanks,  
Tom Millberg  
KEY ACCOUNT MANAGER  
North End Associates

### Authentication Record:

Authentication Record: When a Registered Receipt™ email record is submitted to RMail, our systems authenticate the receipt's integrity and, if authentic, reconstruct the original message content along with forensic evidentiary transaction data.

The Receipt Authentication record reconstructs the original transaction without any storage anywhere except the Registered Receipt itself. And, if the original email was sent encrypted, the reconstructed message content also proves fact of encrypted delivery.

The Receipt Authentication record includes SMTP logs, SMTP history, HTTP records and DSN records.

The Authentication record reconstructs original email, including email content and attachments.

# Email Lifecycle & Popularity Report

## Email Activity Report

Active Tracker™ Intelligence

Original Recipient: jim@insurancegrp.com

Security: Green

Opens: 3

Locations: 2



### Risk Details

Time	Activity	Detail	Locale	Location: Country	Location (IP)	Network	Risk
09/15/2022 08:12:46 UTC	Open	M	Frankfurt, Hesse	Germany	52.72.5.168	T-Mobile	Green
09/13/2022 12:54:18 UTC	Open		Boston, MA	USA	94.92.53.178	Verizon	Green
09/12/2022 02:15:17 UTC	Open		Boston, MA	USA	94.52.53.178	Verizon	Green

### Original Message Details

Original Send Time: 09/12/2022 1:33:52 UTC

Transaction ID: E64B9039C2CE5914F42EE61BCADAB09C55B94832

### Metadata:

```
[IP Address: 41.67.191.255] [Time Opened: 09/15/2022 08:12:48 AM] [REMOTE_HOST: 192.168.10.153] [HTTP_HOST: open.r1.rpost.net] [SCRIPT_NAME: /open/images/LGy25hw0Z65CNlyOLyZCLCuMKdk95gm4vir26bBCMDlx.gif] HTTP_ACCEPT:*/ HTTP_ACCEPT_ENCODING:gzip, deflate HTTP_HOST:open.r1.rpost.net HTTP_USER_AGENT:Mozilla/4.0 (compatible; ms-office; MSOffice 16) HTTP_X_FORWARDED_FOR:183.82.2.55 HTTP_X_FORWARDED_PROTO:https HTTP_X_FORWARDED_PORT:443 HTTP_X_AMZN_TRACE_ID:Root=1-632d2601-68f7d3e527e10ac35f151b35 HTTP_UA_CPU:AMD64 Accept: */* Accept-Encoding: gzip, deflate Host: open.r1.rpost.net User-Agent: Mozilla/4.0 (compatible; ms-office; MSOffice 16) X-Forwarded-For: 183.82.2.55 X-Forwarded-Proto: https X-Forwarded-Port: 443 X-Amzn-Trace-Id: Root=1-632d2601-68f7d3e527e10ac35f151b35 ua-cpu: AMD64 /LM/W3SVC/5/ROOT 256 2048 C=US, S=VA, L=Herndon, O=Network Solutions L.L.C., CN=Network Solutions DV Server CA 2 CN=tracking.rpost.com 0 CGI/1.1 on 256 2048 C=US, S=VA, L=Herndon, O=Network Solutions L.L.C., CN=Network Solutions DV Server CA 2 CN=tracking.rpost.com 5 /LM/W3SVC/5 192.168.10.186 /open/images/LGy25hw0Z65CNlyOLyZCLCuMKdk95gm4vir26bBCMDlx.gif 192.168.10.153 192.168.10.153 46808 GET /open/images/LGy25hw0Z65CNlyOLyZCLCuMKdk95gm4vir26bBCMDlx.gif open.r1.rpost.net 443 1 HTTP/1.1 Microsoft-IIS/8.5 /open/images/LGy25hw0Z65CNlyOLyZCLCuMKdk95gm4vir26bBCMDlx.gif */* gzip, deflate open.r1.rpost.net Mozilla/4.0 (compatible; ms-office; MSOffice 16) 183.82.2.55 https 443 Root=1-632d2601-68f7d3e527e10ac35f151b35 AMD64
```

RPost patented (rpost.com/patents) including US patent applications 17663425, 63/201,857, 63/366,685, 63/366,661 and other applications.

- (M) = activity determined to be on a mobile device.
- (VPN) = activity was detected at an anonymizing VPN endpoint location.
- Location = registered location of the detected network.
- Network = registered network associated with the internet protocol.

Senders can now gain insights into the popularity of their email and the amazing journey their message takes as it is forwarded along.

# Email Eavesdropping™ Alerts for Wire-Fraud Pre-Emption

### Email Activity Report

### Email Eavesdropping™ Alert

Original Recipient: David.Smith@northwestinsurance.com

Security: **Red**

Opens: **3**

Locations: **2**



**Pre-empt cybercrime.  
After the hook is in, before the steal.**

Email Age: 15 days 1 hour 4 minutes

Risk Details: All Activities

Time (UTC)	Activity	Location	Country	Network Addr.	Network	Risk
09/15/2022 08:12:48	Open (VPN)	Ikeja, Lagos	Nigeria	41.67.191.255	Netcom Africa	Red
09/13/2022 17:06:22	Open	Boston, MA	USA	94.92.53.178	Verizon	Green
09/13/2022 12:54:18	Open	Boston, MA	USA	94.52.53.178	Verizon	Green

#### Original Message Details

Subject: Weekly analysis  
Original Send Time: 09/13/2022 03:20:00 UTC  
Transaction ID: A4BD52B62EE9862A5FDD8BF336A99E2D69FEF54A

#### Metadata:

```
[IP Address: 41.67.191.255] [Time Opened: 09/15/2022 08:12:48 AM] [REMOTE_HOST: 192.168.10.153] [HTTP_HOST: open.r1.rpost.net] [SCRIPT_NAME: /open/images/LGy25hw0Z65CNlyOLyZCLCuMKdk95gm4vir26bBCMDlx.gif] HTTP_ACCEPT: */* HTTP_ACCEPT_ENCODING:gzip, deflate HTTP_HOST:open.r1.rpost.net HTTP_USER_AGENT:Mozilla/4.0 (compatible; ms-office; MSOffice 16) HTTP_X_FORWARDED_FOR:183.82.2.55 HTTP_X_FORWARDED_PROTO:https HTTP_X_FORWARDED_PORT:443 HTTP_X_AMZN_TRACE_ID:Root=1-632d2601-68f7d3e527e10ac35f151b35 HTTP_UA_CPU:AMD64 Accept: */* Accept-Encoding:gzip, deflate Host: open.r1.rpost.net User-Agent: Mozilla/4.0 (compatible; ms-office; MSOffice 16) X-Forwarded-For: 183.82.2.55 X-Forwarded-Proto: https X-Forwarded-Port: 443 X-Amzn-Trace-Id: Root=1-632d2601-68f7d3e527e10ac35f151b35 ua-cpu: AMD64 /LM/W3SVC/5/ROOT 256 2048 C=US, S=VA, L=Herndon, O=Network Solutions L.L.C., CN=Network Solutions DV Server CA 2 CN=tracking.rpost.com 0 CGI/1.1 on 256 2048 C=US, S=VA, L=Herndon, O=Network Solutions L.L.C., CN=Network Solutions DV Server CA 2 CN=tracking.rpost.com 5 /LM/W3SVC/5 192.168.10.186 /open/images/LGy25hw0Z65CNlyOLyZCLCuMKdk95gm4vir26bBCMDlx.gif 192.168.10.153 192.168.10.153 46808 GET /open/images/LGy25hw0Z65CNlyOLyZCLCuMKdk95gm4vir26bBCMDlx.gif open.r1.rpost.net 443 1 HTTP/1.1 Microsoft-IIS/8.5 /open/images/LGy25hw0Z65CNlyOLyZCLCuMKdk95gm4vir26bBCMDlx.gif */* gzip, deflate open.r1.rpost.net Mozilla/4.0 (compatible; ms-office; MSOffice 16) 183.82.2.55 https 443 Root=1-632d2601-68f7d3e527e10ac35f151b35 AMD64
```

RPost patented (rpost.com/patents) including US patent applications 17663425, 63/201,857, 63/366,685, 63/366,661 and other applications.

(M) = activity determined to be on a mobile device.  
(VPN) = activity was detected at an anonymizing VPN endpoint location.  
Location = registered location of the detected network.  
Network = registered network associated with the internet protocol.

If the RMail **active threat hunting** technology identifies unusual activity patterns, RMail generates an Email Eavesdropping™ instant alert, and notifies in real-time IT admins (and optionally senders) with forensic details.

BEC lures start with cybercriminals targeting their victims by eavesdropping on email from sender to recipient, to siphon off email, analyze it, copy it with slight modifications (e.g., payment instructions), and then pivot replies so they route in a loop back to the cybercriminal.

With Email Eavesdropping™ alerts, every email sent out of the organization has every activity associated with it analyzed forensically, for a period of time. These alerts include all the email forensics so that IT security specialists can validate and take immediate action, **before the cybercriminal lures users into mis-wiring money to the criminal's bank.**

# Security Breach Locator™ Report



**REGISTERED ENCRYPTION™**  
CERTIFICATE EVIDENCING END-TO-END SECURITY

This privacy certificate provides proof of the privacy status of the associated email, from the original sender through to each recipient. Together with the Registered Receipt™ it is attached to, a user may authenticate the data in this certificate along with the original message content and all of the delivery history and timestamp details. To authenticate the information in this certificate, follow the instructions on the associated receipt. Patented and Pending US 16866135.

Message Envelope				
Message ID:	C8737FB9CF1519A2053C44E0056FDF5C39DD8645			
From:	MelanieJames <mjames@newinsurance.com>			
Subject:	Policy Updates			
To:	<wanda.mcgrath@holdingsusa.net> <jonathan.ogden@holdingsusa.net> <richard.clark@associatesolutions.net>			
Cc:				
Bcc:				
Received by RMail System:	05/26/2022 07:39:38 PM (UTC)			
Client Code:				

Outbound Details: Sender to RMail Cloud					Inbound Details: RMail Cloud to Recipient					
Original Sender	Internet Hop ID	Security Details		Time Inducted	Encryption Status	End Recipient	Security Details		Time Received	Encryption Status
		Message Level	Transmission				Message Level	Transmission		
mjames@newinsurance.com	smtp13.relay.iad3a.emailsrvr.com (Authenticated sender: mjames-AT-newinsurance.com)	RSA-AES256	TLSv1.2*	05/26/2022 07:39:34 PM (UTC)	Best+	wanda.mcgrath@holdingsusa.net	TLSv1.2		05/26/2022 07:39:38 PM (UTC)	Best
mjames@newinsurance.com	smtp13.relay.iad3a.emailsrvr.com (Authenticated sender: mjames-AT-newinsurance.com)	RSA-AES256	TLSv1.2*	05/26/2022 07:39:34 PM (UTC)	Best+	jonathan.ogden@holdingsusa.net	TLSv1.1		05/26/2022 07:39:38 PM (UTC)	Acceptable
mjames@newinsurance.com	smtp13.relay.iad3a.emailsrvr.com (Authenticated sender: mjames-AT-newinsurance.com)	RSA-AES256	TLSv1.2*	05/26/2022 07:39:34 PM (UTC)	Best+	richard.clark@associatesolutions.net	PDF-AES256	TLSv1.0	05/26/2022 07:39:38 PM (UTC)	Best+

Outbound Details: Sender to RMail Cloud					Inbound Details: RMail Cloud to Recipient					
Original Sender	Internet Hop ID	Security Details		Time Inducted	Encryption Status	End Recipient	Security Details		Time Received	Encryption Status
		Message Level	Transmission				Message Level	Transmission		
mjames@newinsurance.com	smtp13.relay.iad3a.emailsrvr.com (Authenticated sender: mjames-AT-newinsurance.com)	RSA-AES256	TLSv1.2*	05/26/2022 07:39:34 PM (UTC)	Best+	wanda.mcgrath@holdingsusa.net	TLSv1.2		05/26/2022 07:39:38 PM (UTC)	Best
mjames@newinsurance.com	smtp13.relay.iad3a.emailsrvr.com (Authenticated sender: mjames-AT-newinsurance.com)	RSA-AES256	TLSv1.2*	05/26/2022 07:39:34 PM (UTC)	Best+	jonathan.ogden@holdingsusa.net	TLSv1.1		05/26/2022 07:39:38 PM (UTC)	Acceptable
mjames@newinsurance.com	smtp13.relay.iad3a.emailsrvr.com (Authenticated sender: mjames-AT-newinsurance.com)	RSA-AES256	TLSv1.2*	05/26/2022 07:39:34 PM (UTC)	Best+	richard.clark@associatesolutions.net	PDF-AES256	TLSv1.0	05/26/2022 07:39:38 PM (UTC)	Best+

End-to-End Security Summary			
Original Sender	Original Recipient	Overall Encryption Status	Status Description
mjames@newinsurance.com	wanda.mcgrath@holdingsusa.net	★★★★★	Best encryption from sender device, best to recipient gateway
mjames@newinsurance.com	jonathan.ogden@holdingsusa.net	★★★★☆	Best encryption from sender device, acceptable to recipient.
mjames@newinsurance.com	richard.clark@associatesolutions.net	★★★★★	Best encryption from sender device, best+ to recipient.

For more information about RMail® services, visit [www.rmail.com](http://www.rmail.com). An RPost® Technology

If an email is identified as being eavesdropped on, the Registered Encryption™ report identifies the most likely security gaps; **and/or provides audit-ready proof that the security gap must have been after the recipient forwarded the message onward --- and not a fault of the sender.**

The security forensics provided by RMail are fact, and allow IT admins to easily justify and demonstrate their hypothesis about where cybercriminals may have accessed an email in the path from sender to recipient, even if the breach occurred at the recipient's end.

# Aggregate Eavesdropping Heartbeat™ Monitor

### AGGREGATE EAVESDROPPING HEARTBEAT™ MONITOR

Date: 11-01-2022

Sender Domains: northendassoc.com, northendassoc.co.uk

Red Alerts: 8

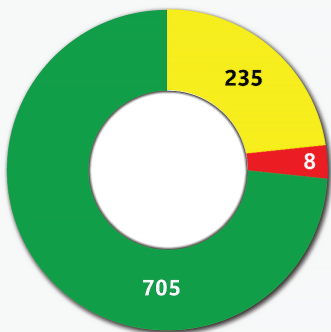
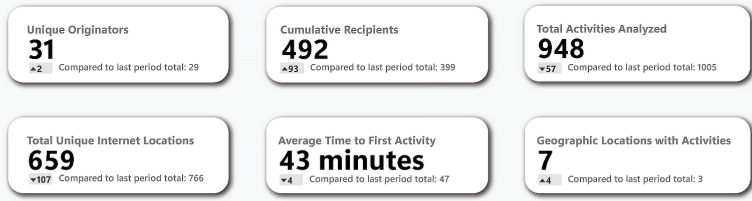

Activities by Risk Level

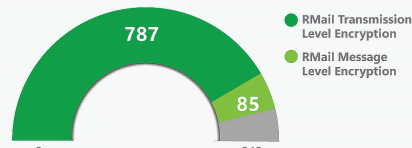

Encrypted Emails by Unique Recipients

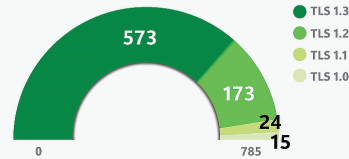

Transmission Encryption Security Report

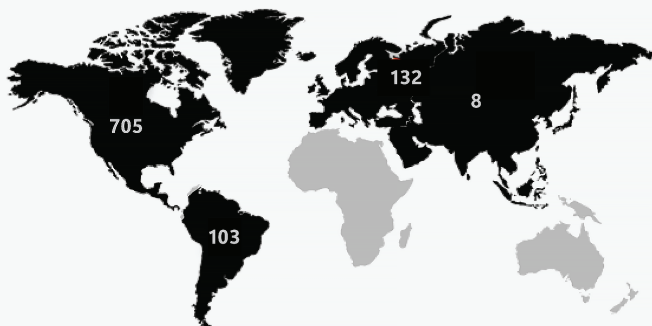

Unique Activities per Region

The Aggregate Eavesdropping Heartbeat™ Monitor offers a daily snapshot of eavesdropping risks for MSPs or IT admins. This aggregate report provides peace of mind by forensically monitoring the journey of all outbound messages to the recipient and beyond.

IT Admins or MSPs can swiftly investigate further if they see any high alerts or unusual activity across all users, all domains, and all companies that they manage or monitor security for.



### RMail Outbound Security Cloud

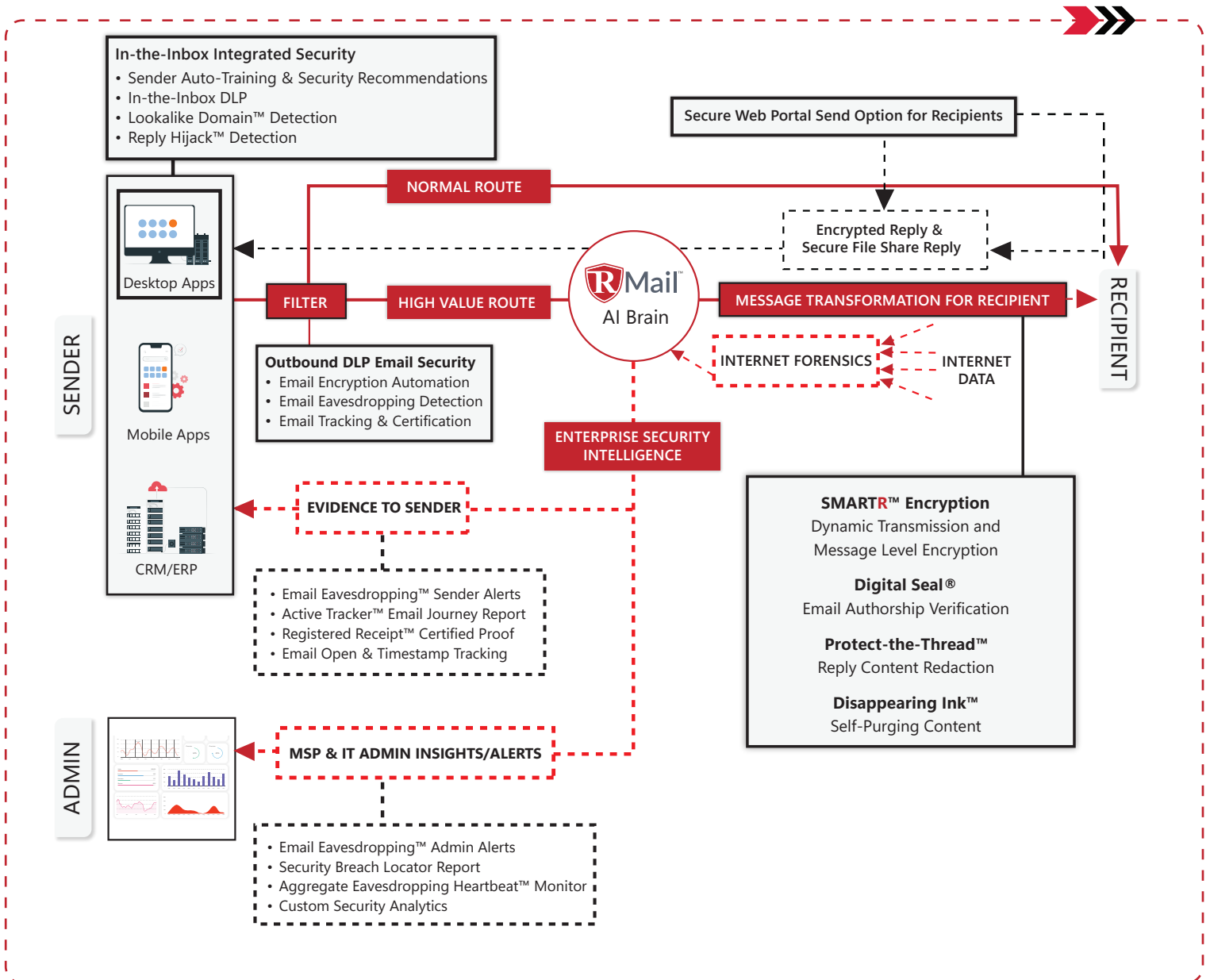

### Perfect Harmony, Enhance the Outbound

Keep your existing inbound email security – and even your outbound DLP if you so choose. Add RMail outbound security gateway, in-the-inbox integrated cloud email security, and in-the-ether e-security content controls: all, some or one. RMail harmoniously extends your existing email security systems, adding elegantly-easy encryption user experiences, unique BEC targeted attack detection, and more, with AI DLP automation.